

SPECIFICATION

Current Rate:3 AMP
 Insulation Resistance:≥1000MΩ at V=100V.
 Contact Resistance:≤4mΩ/Contact
 Dielectric voltage:1000V AC for one minute
 Operation Temperature:-40°C to +105°C

MATERIAL

Insulator:PBT(UL94V-0)
 Contact Pin:Copper Alloy

ORDER INFORMATION

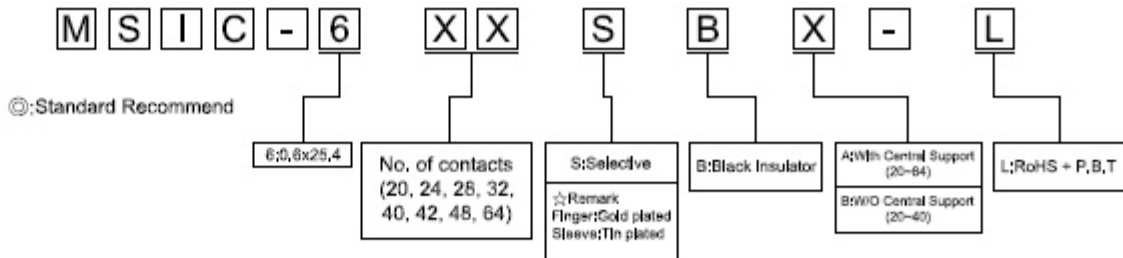

No. of Contacts	Dim. A	Dim. B	Type
20	25.40	22.86	W/O Central Support
24	30.48	27.94	
28	35.56	33.02	
32	40.64	38.10	
40	50.80	48.26	
20	25.40	22.86	W/In Central Support
24	30.48	27.94	
28	35.56	33.02	
32	40.64	38.10	
40	50.80	48.26	
42	53.34	50.80	
48	60.96	58.42	
64	81.28	78.74	

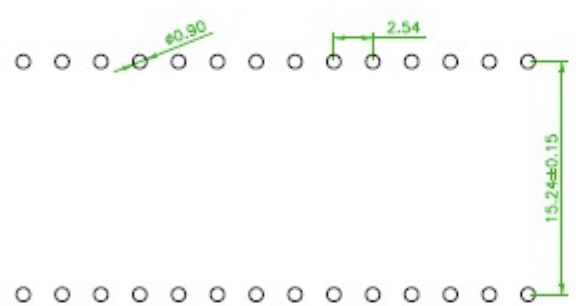
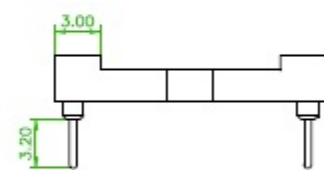
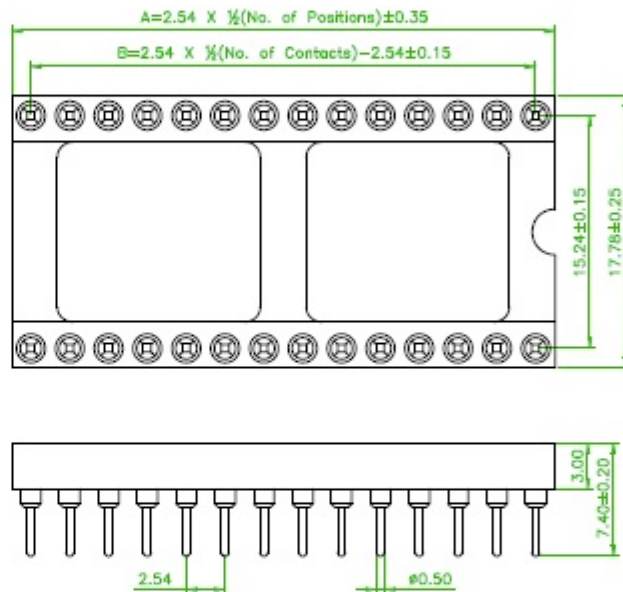

P.C.B LAYOUT

	品名 TITLE	MACHINE PIN SOCKET IC STRAIGHT TYPE 2.54mm				
	品號 PART NO.	MSIC-6XX-L			日期 DATE	2009/11/18
	圖號 DRAWING NO.	MSIC-6XX-L	版本 REV.	A	繪圖 DRAWN	Sinnys
	客戶品號 CUSTOMER P/N		比例 SCALE	FREE	核對 CHECKED	Paul
	公差 TOLERANCE	.X ±0.30 .XX ±0.20	單位 UNIT	mm	核准 APPROVED	James

AREA	REV.	DESCRIPTION	DATE